

Key Features:

- Up to 120 minutes Fire Rated
- Tested in Internal & External Walls
- CE Marked
- Low Profile design
- No metal sleeving or boxing out required
- Approved for plasterboard partitions and ablative coated fire batts



TENMAT's FIREFLY 109+ Vent Duct Fire Sleeve LPs (Low Profile) provide up to 120 minutes' fire resistance for all common PVC ventilation ducts. The Low Profile Vent Duct Fire Sleeves offer industry leading fire performance with low material thickness through the use of **TENMAT's** expertise in high expansion intumescent technology.

The low profile design allows tight fitting against the ceiling soffit without the need to remove the top edge, aided by the compressible nature of the FIREFLY 109 intumescent material.

The product can be slit to allow retro fitting over duct work and the unique vacuum formed shape ensures that the product expands and seals the ducting in the event of a fire without the need for any additional metal cage or sleeving.

Product Dimensions

Duct Size	Nominal Thickness	Nominal External Width/Diameter	Nominal External Height	Length	Fire Rating
110x54 mm	10-15 mm	134mm	83mm	180 mm*	Up to EI120
204x60 mm	10-15 mm	228mm	89mm	180 mm	Up to EI120
204x60 mm	10-15 mm	228mm	89mm	360 mm	Up to EI120
220x90 mm	10-15 mm	244mm	124mm	180 mm	Up to EI120
220x90 mm	10-15 mm	244mm	124mm	360 mm	Up to EI120
100 mm (103 mm)	15 mm	134mm	-	180 mm	Up to EI120
125 mm (127 mm)	15 mm	160mm	-	280 mm	Up to EI120
150 mm (155 mm)	20 mm	200mm	-	280 mm	Up to EI120

All dimensions given are nominal. To ensure required friction fit within the substrate, the sleeve should be measured on site before cutting holes. *For longer lengths, please contact TENMAT.

Examples of Applications & Approvals

Independently Third Party Assessed:

30 Minute Partitions

- Single Board from 72mm upwards

60 Minute Partitions

- Single and Double Board Systems
- Single Layer Ablative Coated Fire Batt

120 Minute Partitions

- Double Board Systems
- Double Layer Ablative Coated Fire Batt

Multiple Duct Penetrations

- Up to 3No. Side by side ducts
- Up to 2no. Stacked ducts
- Mixed Sizes

Tested through External Walls—SFS construction

CE MARK Approved:

3rd Party Assessed and Audited

BS EN 1366-3 Fire Tested

Uncapped/Uncapped tested as required for ventilation systems

Fire Tested and Assessed for all common sizes of ducting

Example Approved Applications

For details of further applications please contact **TENMAT**.

TENMAT's Vent Duct Fire Sleeve LP is approved for a wide range of applications. All details for approved applications can be seen in the ETA and/or assessment reports which are available on request.

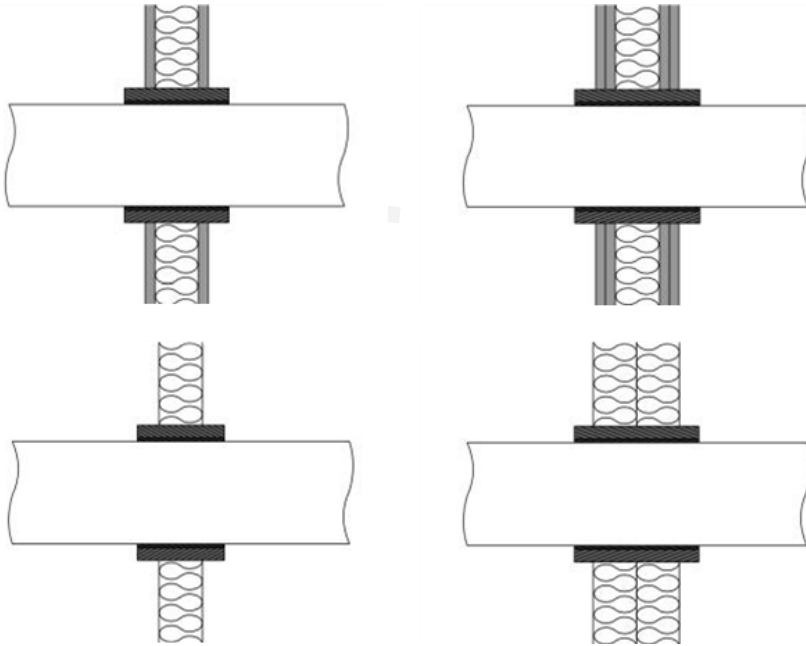

Single or double layer plasterboard. Approved with or without cavity insulation for all duct sizes listed

Multiple duct penetrations, including side by side and stacked, approved for partitions and fire batt applications (rectangular ducting only).

Tested in External Walls—contact TENMAT for specific details.

General Fitting Instructions

For detailed fitting instructions for various applications please contact **TENMAT**.



- Installation requirements detailed in the fire test evidence must be followed in addition to below:
- Use the Fire Sleeve as a template when cutting the plasterboard to provide a snug fit around the Fire Sleeve
- Make a slit along sleeve length to allow fitting around pre-installed ducts



- Fit sleeve around duct
- Slit should be resealed with Aluminium Foil Repair Tape provided
- Slide Fire Sleeve until central within wall



- The Fire Sleeve must protrude each side of the wall by min 25mm (partitions)/40mm (single fire batts)/75mm (for 125 and 150mm ducts)
- For protrusion details when used in External Walls, please contact **TENMAT**
- Fire Sleeves cannot be joined to increase the length. Longer versions are available from **TENMAT**
- Plasterboard should be a snug fit, however any gaps (up to 5mm) should be sealed with intumescent sealant